

# Wireless Setup Guide for iOS

## Step 1:

Access your apps list on your device and select the “Settings” icon as seen on the right.



## Step 2:

Select Wi-Fi

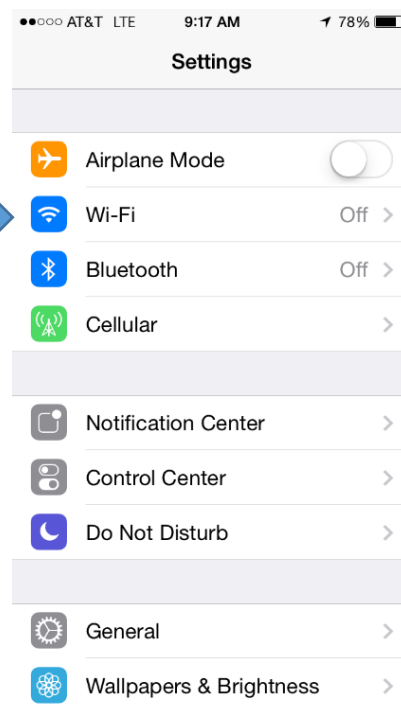

## Step 3:

Make sure WiFi is turned ON, if not, select the slider to activate “ON”

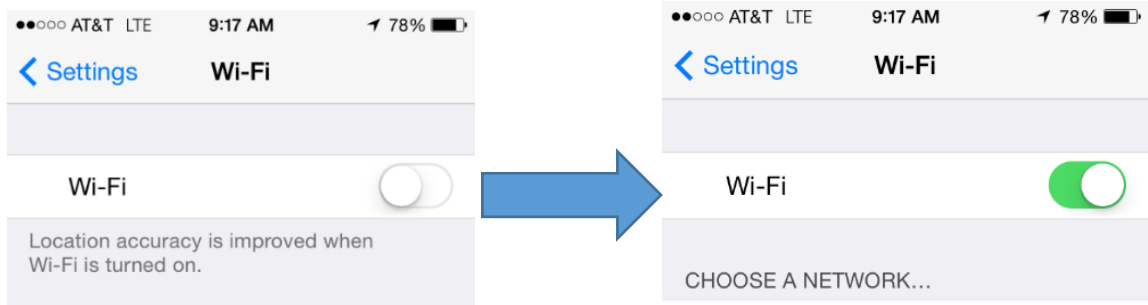

## Step 4:

**Faculty/Staff:** Select “HCCC”

**Students:** Select “student”



## Step 5:

Enter your Login Credentials substituting Username and Password with your MyHudson Portal Account information. Then click “Join”.

### STUDENT EXAMPLE:

Student Name: *John Smith*  
 Student ID# 2243333  
 Born: June 17, 1991  
 Username = [jsmith3333@live.hccc.edu](mailto:jsmith3333@live.hccc.edu)  
 Password = 061791

### FACULTY & STAFF EXAMPLE

Employee Name: *John Smith*  
 Username = [jsmith@hccc.edu](mailto:jsmith@hccc.edu)  
 Password = (same as Portal credentials)

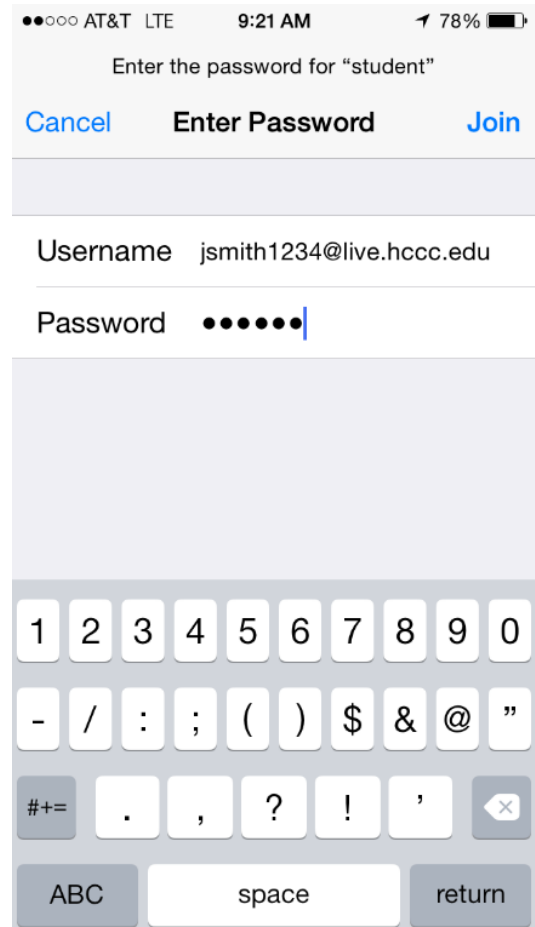

AT&T LTE 9:21 AM 78%

Enter the password for “student”

Cancel Enter Password Join

Username [jsmith1234@live.hccc.edu](mailto:jsmith1234@live.hccc.edu)

Password ●●●●●●

1 2 3 4 5 6 7 8 9 0  
 - / : ; ( ) \$ & @ ”  
 #+= . , ? ! ’ ×  
 ABC space return

## Step 6:

Select “Accept” to successfully be connected.

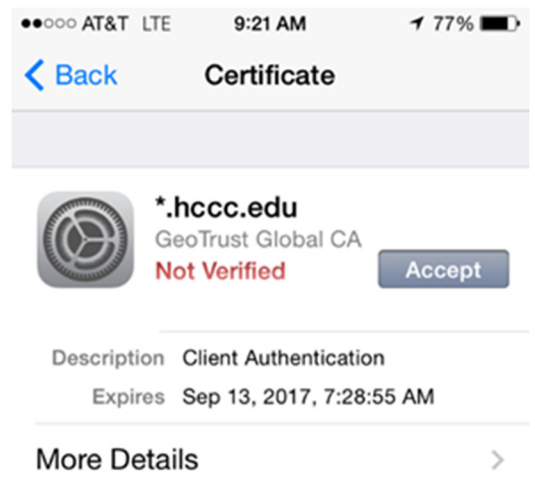

AT&T LTE 9:21 AM 77%

< Back Certificate

 \*.hccc.edu  
 GeoTrust Global CA  
 Not Verified Accept

Description Client Authentication  
 Expires Sep 13, 2017, 7:28:55 AM

More Details >