

# HCCC WIFI GUIDE

## CHROMEBOOK

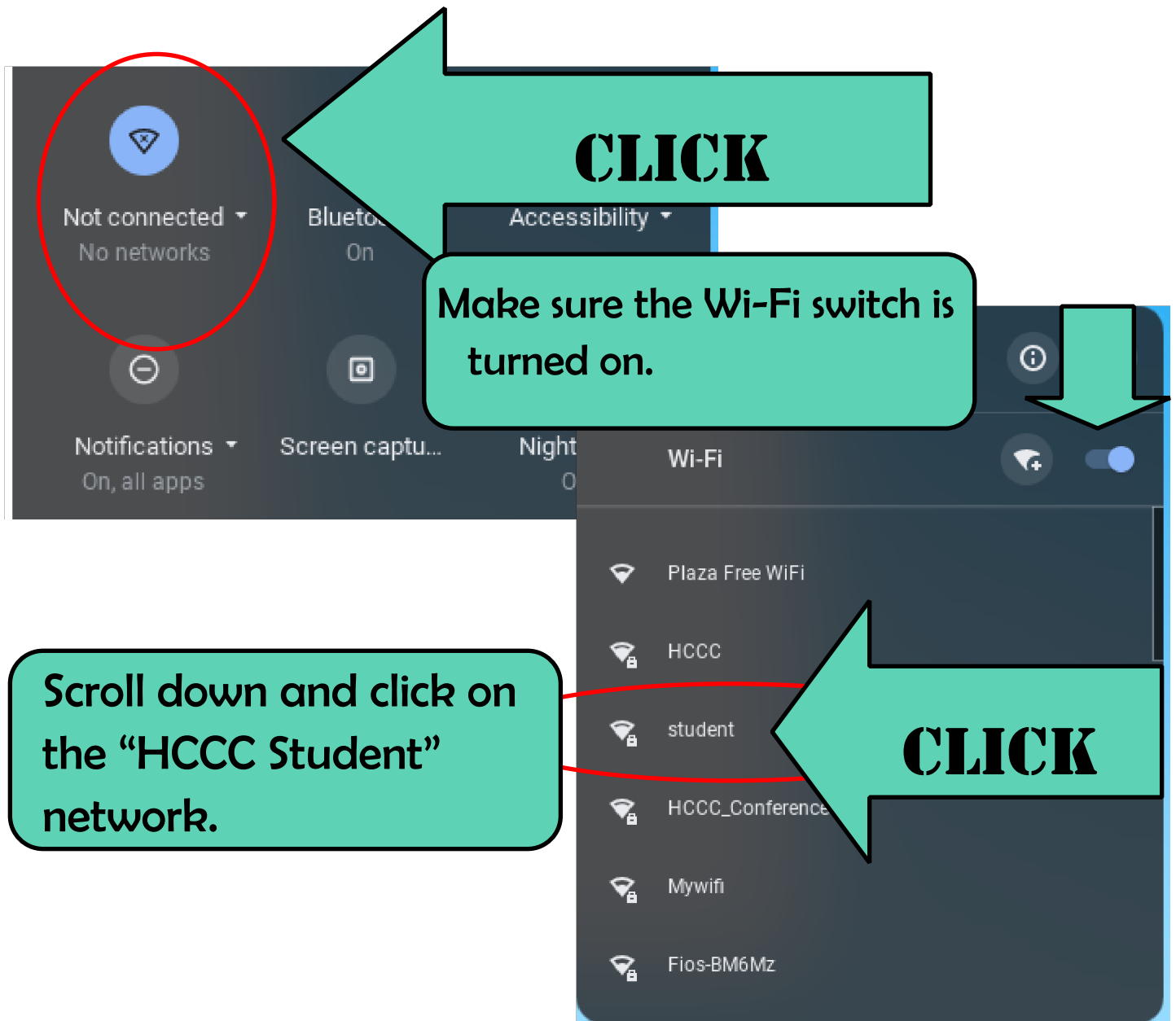
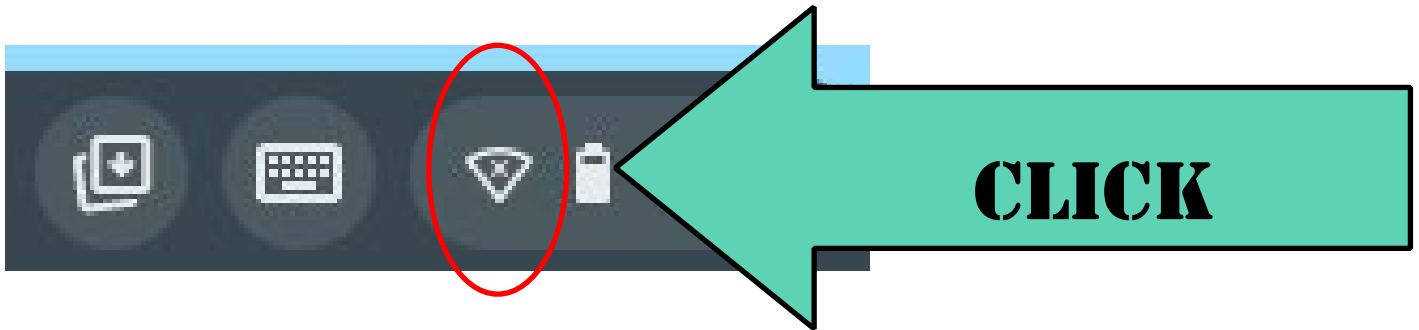

## Join Wi-Fi network

SSID

student

Security

EAP

EAP method

PEAP

EAP Phase 2 authentication

MSCHAPv2

Server CA certificate

Do not check

Identity

## Join Wi-Fi network

Do not check

Identity

jsmith3456@live.hccc.edu

Password

.....

Anonymous Identity

jsmith3456@live.hccc.edu

Save identity and password

Under “EAP method”, choose PEAP.

Under “EAP Phase 2 authentication”, choose MSCHAPv2.

Under “Server CA certificate”, choose “Do not check”.

Under “Identity” and “Anonymous identity”, type in your username and password. Your username is the first letter of your first name, your full last name, and the last 4 numbers of your student ID.

Example: John Smith 0123456 =  
jsmith3456@live.hccc.edu

Enter your current HCCC Password  
Click “Connect”

Cancel

Connect

**CLICK**